

**CMDA (B)/15 No. 1**  
C. No. 61/5939/2013  
Asst. \_\_\_\_\_  
Scrutiny P. A. \_\_\_\_\_  
A.P. \_\_\_\_\_

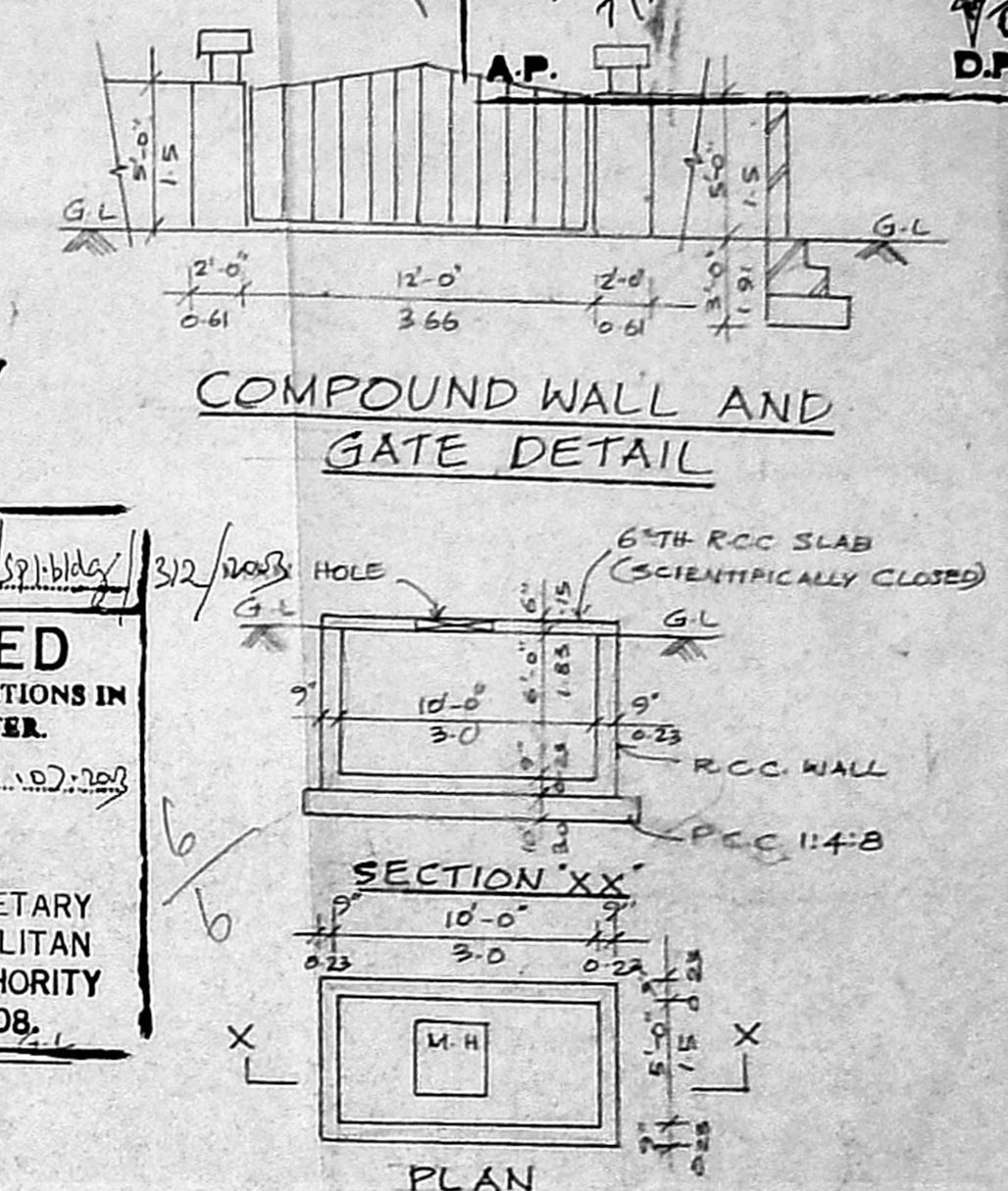

APPROVED  
SUBJECT TO THE CONDITIONS IN THIS OFFICE LETTER.  
FOR MEMBER (SECRETARY) CHENNAI METROPOLITAN DEVELOPMENT AUTHORITY CHENNAI-600 008.

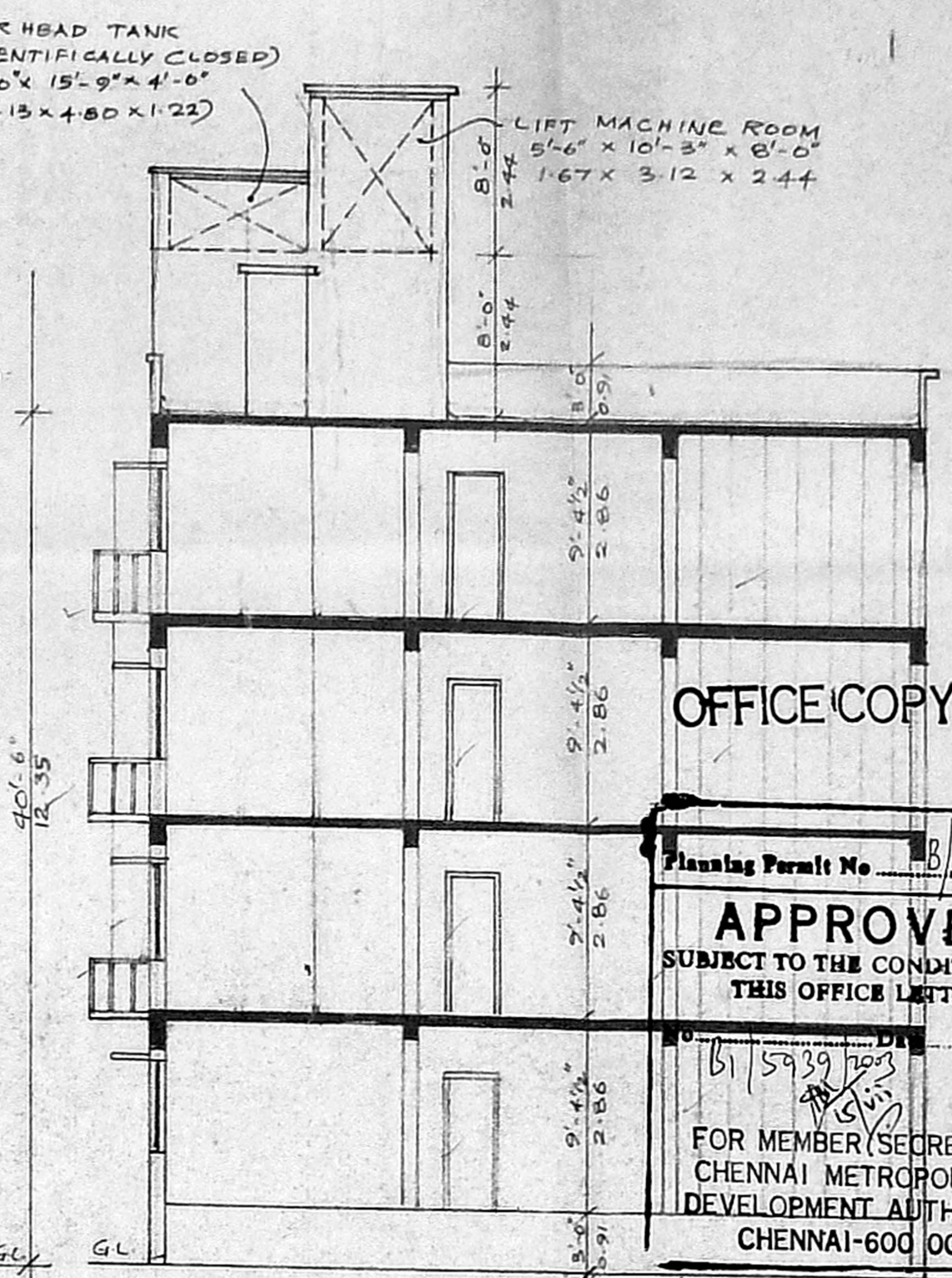
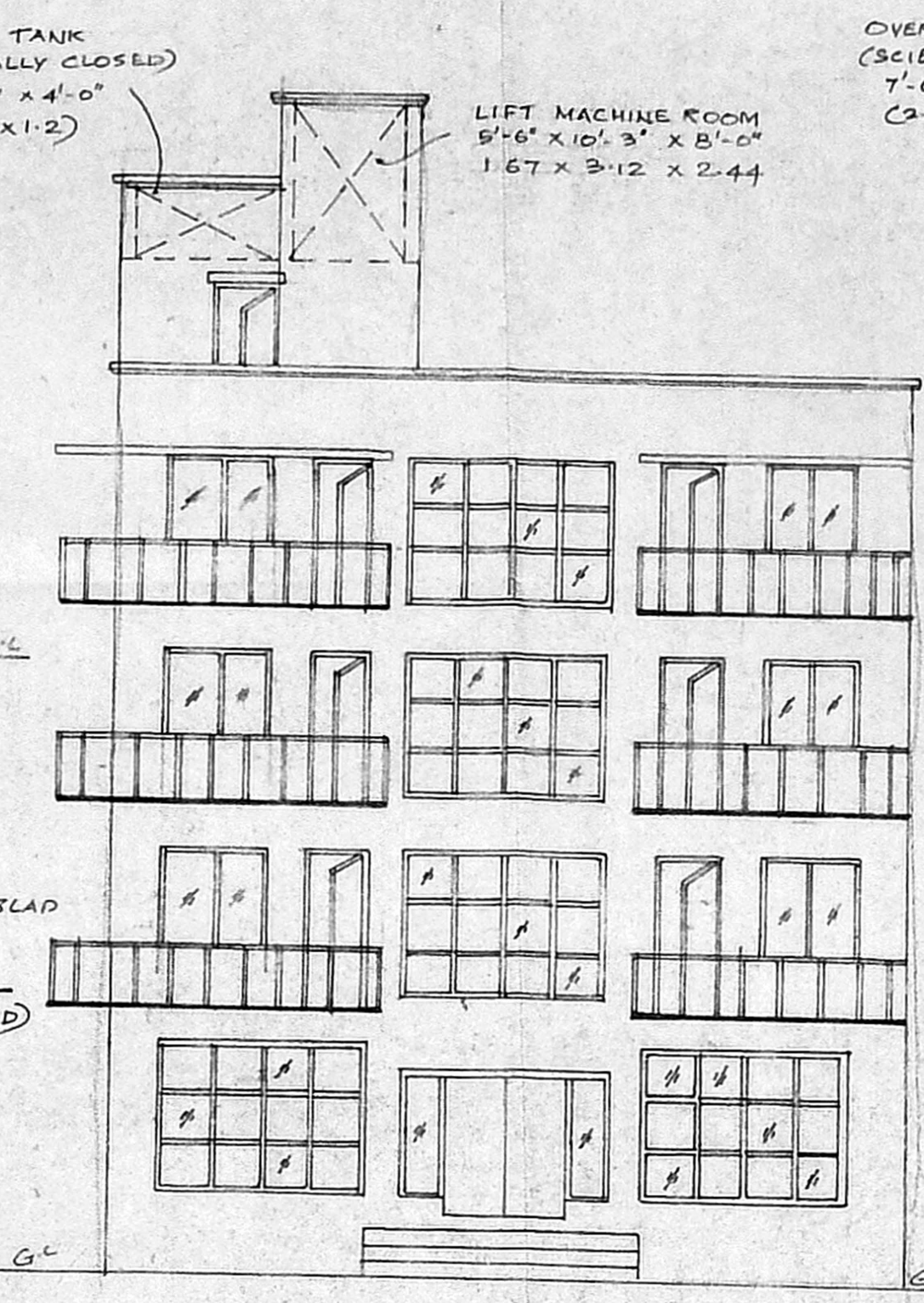
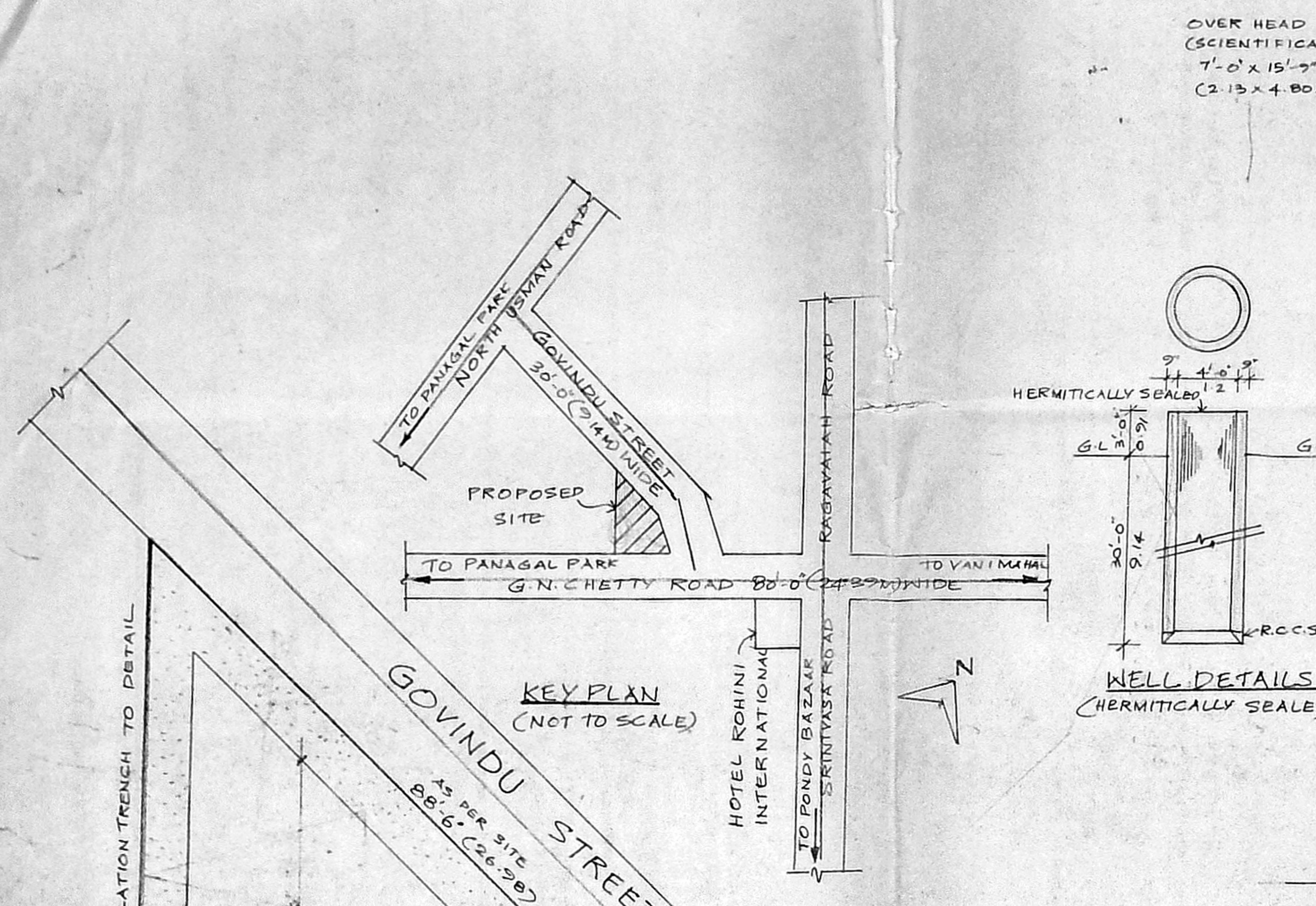
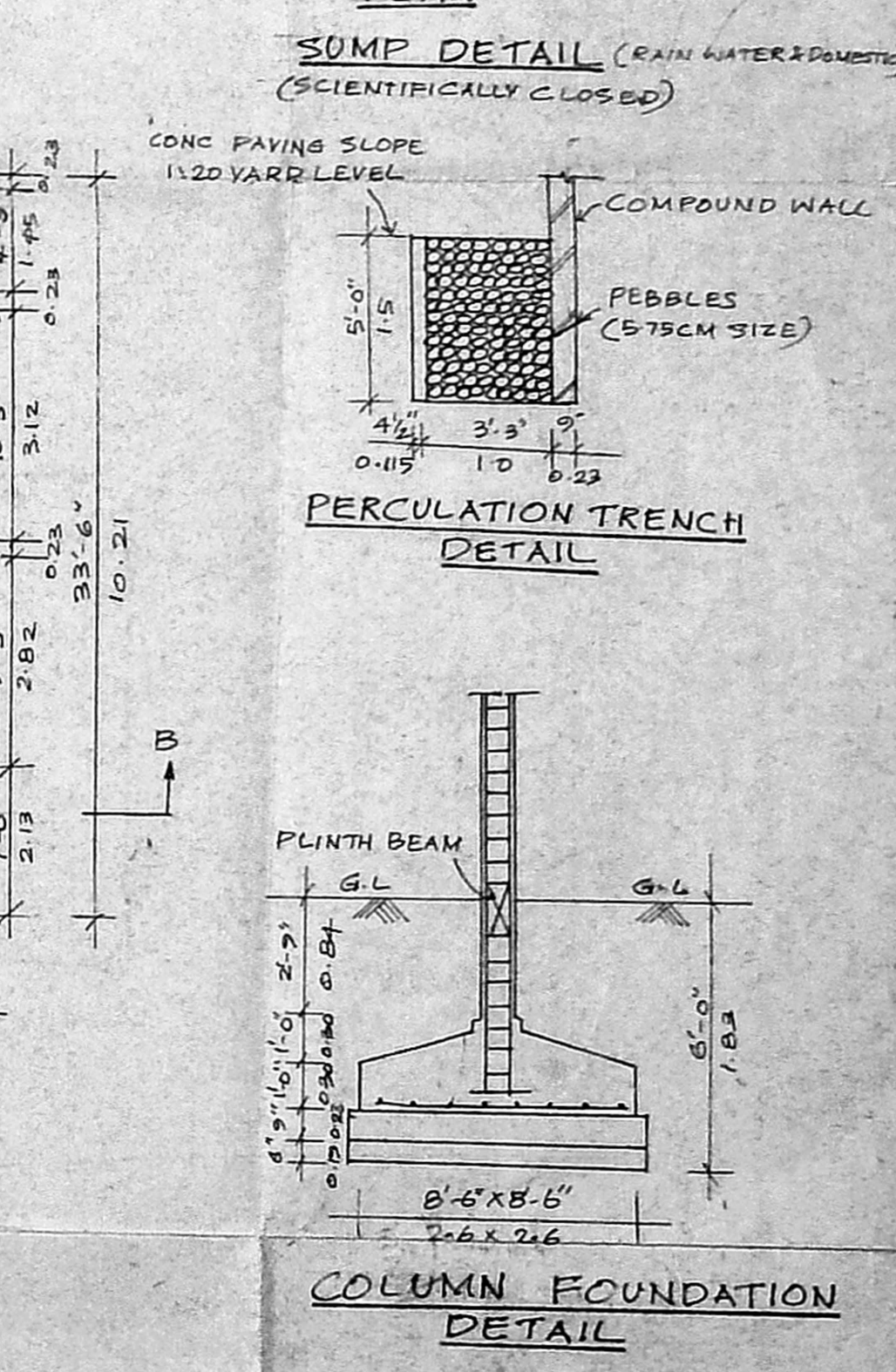
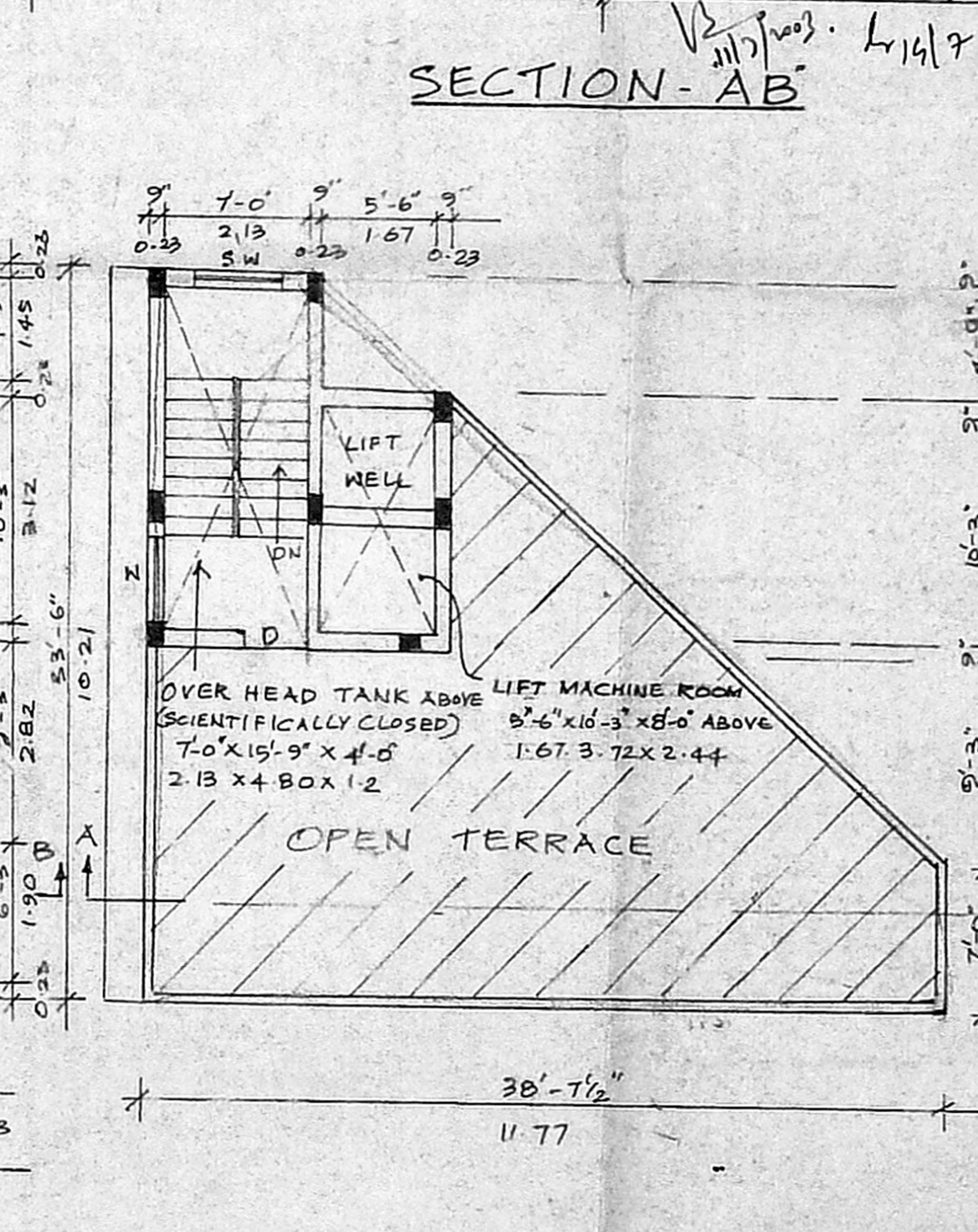
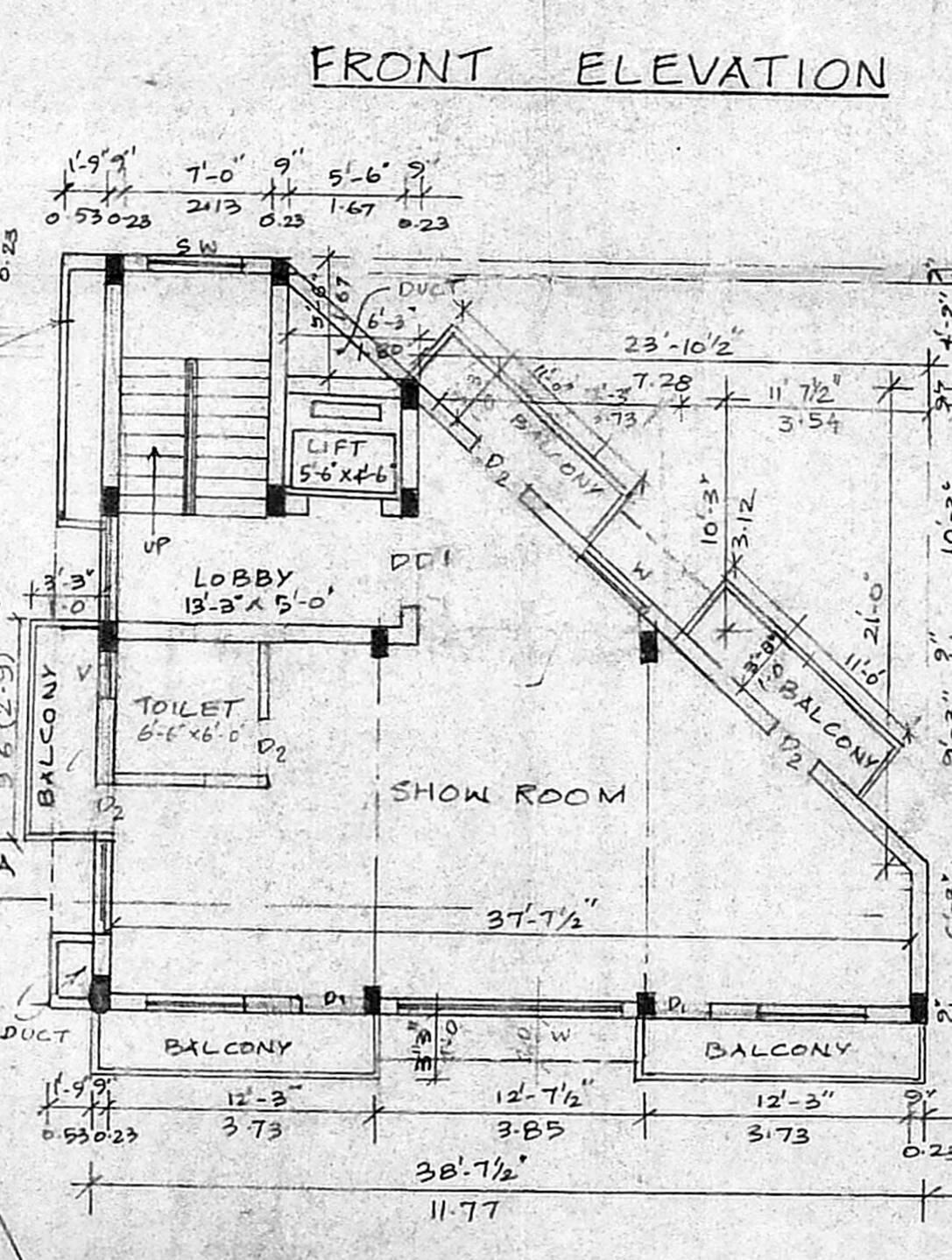
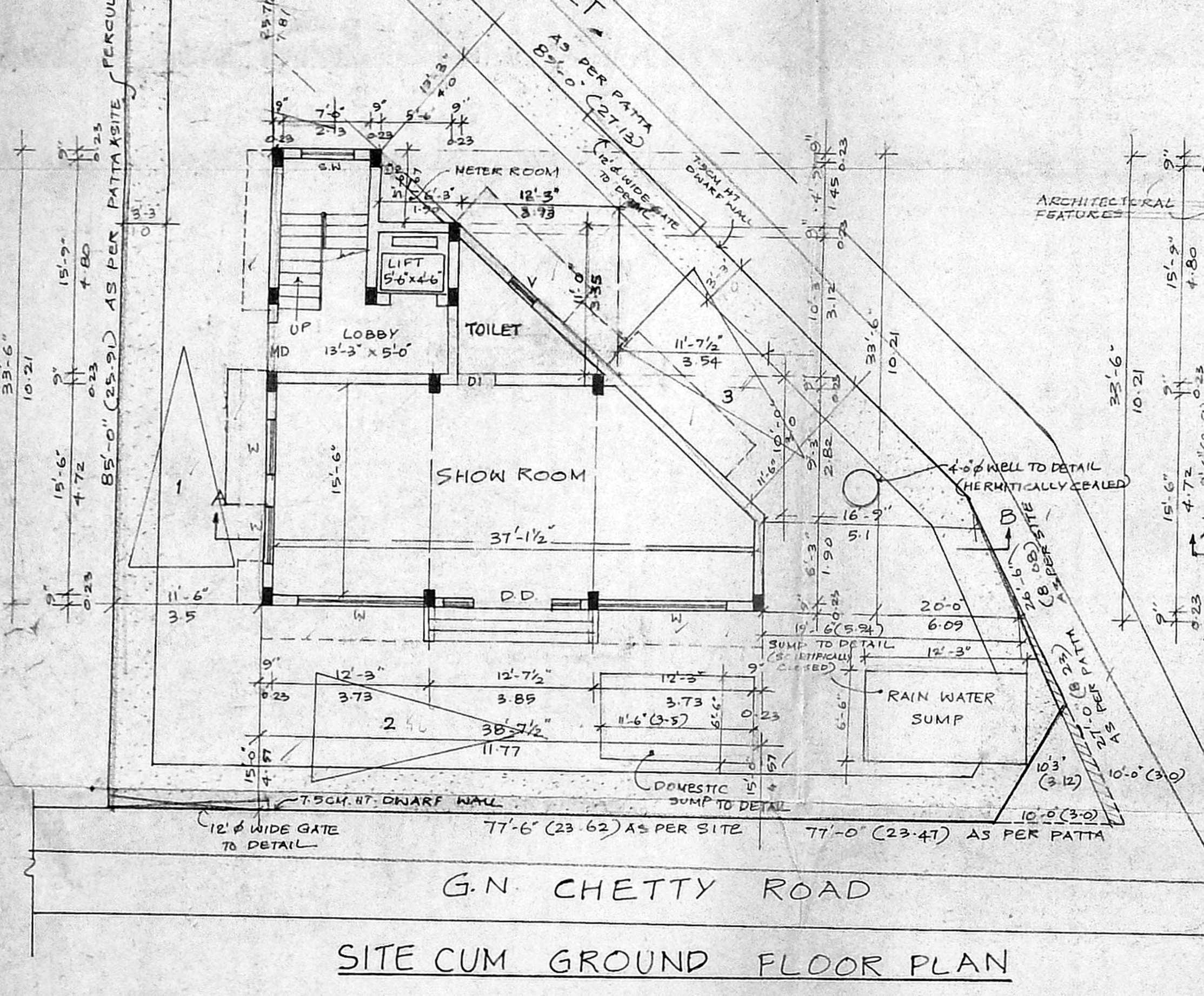

PROPOSED COMMERCIAL BUILDING AT PLOT NO 8, NEW DOOR NO 120 OLD DOOR NO 4, G.N. CHETTY ROAD T. NAGAR, CHENNAI - 600 017. T.S. NO 5339, BLOCK NO 121, MAMBALAM GUINDY TALUK. CHENNAI. EARLIER APPD NO: B/SP/BUILDING/229/02 IN LETTER NO: B/40454/2001 DT 27/10/02

AREA DETAILS	
GROUND FLOOR	: 81.53
FIRST FLOOR	: 98.44
SECOND FLOOR	: 98.44
THIRD FLOOR	: 98.44
TOTAL AREA	: 376.85
SITE AREA	
F.S.I	1.12

- SPECIFICATIONS**
1. COLUMN FOOTING FOUNDATION LAID OVER THE SAND FILLING AND P.C.C. 1:4:8 MAT.
  2. ALL COLUMNS ARE CONNECTED WITH PLINTH BEAM & ROOF BEAM.
  3. P.C.C. 1:4:8 LAID OVER THE SAND FILLING FOR MOSAIC FLOORING
  4. BRICK WORK IN BASEMENT AND SUPERSTRUCTURE WITH C.M. 1:5 MIX.
  5. R.C.C. 1:2:4 MIXED LINTEL LAID OVER THE DOORS, WINDOWS AND OPENINGS.
  6. ALL WALLS AND CEILINGS ARE PLASTERED WITH C.M. 1:5 MIX
  7. ROOF COVERED BY R.C.C. 1:2:4 MIXED ROOF SLAB

**SCHEDULE OF JOINERY**

	FT.	MT
M.D. MAIN DOOR	3'-6" x 7'-0"	1.01 x 2.13
D.D. DOUBLE DOOR	6'-0" x 7'-0"	1.83 x 2.13
DDI DOUBLE DOOR	4'-8" x 7'-0"	1.22 x 2.13
D DOOR	3'-0" x 7'-0"	0.91 x 2.13
DI DOOR	2'-6" x 7'-0"	0.76 x 2.13
W WINDOW	4'-0" x 4'-6"	1.22 x 1.37
S.W. STAIR WINDOW	4'-0" x 4'-0"	1.22 x 1.22
V VENTILATOR	2'-0" x 3'-0"	0.61 x 0.91

**COLOUR INDEX**

PROPOSED BUILDING: [Color swatch]

EXISTING ROAD: [Color swatch]

SITE BOUNDARY: [Color swatch]

SCALE 1"=8'-0" (1:100)

OWNERS SIGNATURE  
MR. V. PRABHAKAR.

LICENCED SURVEYOR  
**S. ATHYAMAN, B.E.**  
CHARTERED ENGINEER  
Class-1, Licenced Surveyor - No. 102  
Corporation of Chennai  
5, Nathamuni Street, T. Nagar,  
Chennai - 17, Mobile : 98410-71243